

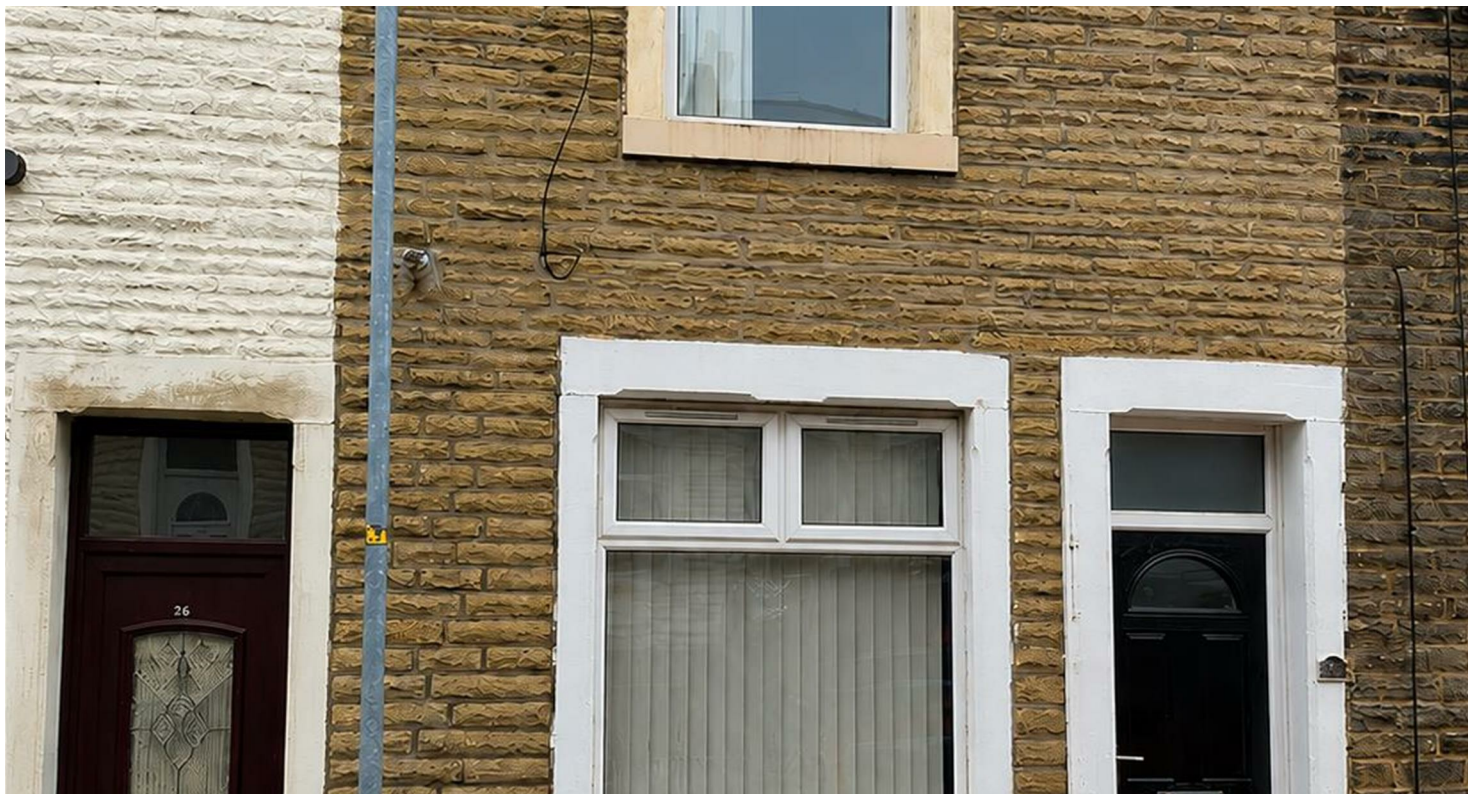

RESIDENTIAL



## 28 Harley Street, Burnley, BB12 6RJ

£90,000

- Two Bedroom Mid-Terraced
- Popular Residential Location
- Tenant in Situ
- Excellent buy-to-let investment opportunity
- Rental Income of £595 PCM

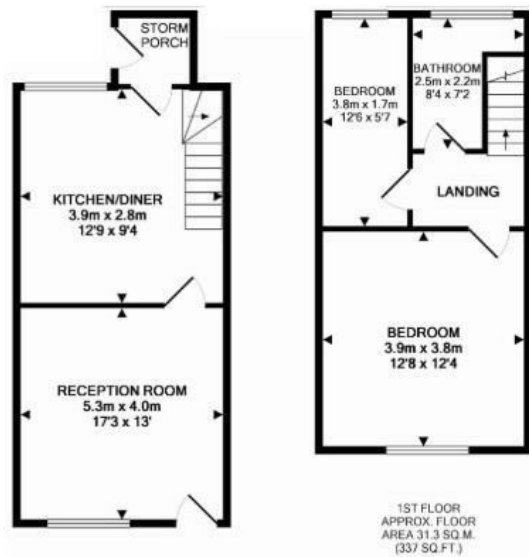

GROUND FLOOR  
APPROX. FLOOR  
AREA 33.5 SQ.M.  
(360 SQ.FT.)

TOTAL APPROX. FLOOR AREA 64.7 SQ.M. (697 SQ.FT.)

Whilst every attempt has been made to ensure the accuracy of the floor plan contained here, measurements of doors, windows, rooms and any other items are approximate and no responsibility is taken for any error, omission or mis-statement. This plan is for illustrative purposes only and should be used as such by any prospective purchaser. The services, systems and appliances shown have not been tested and no guarantee as to their operability or efficiency can be given.  
Made with Metrooix ©2015

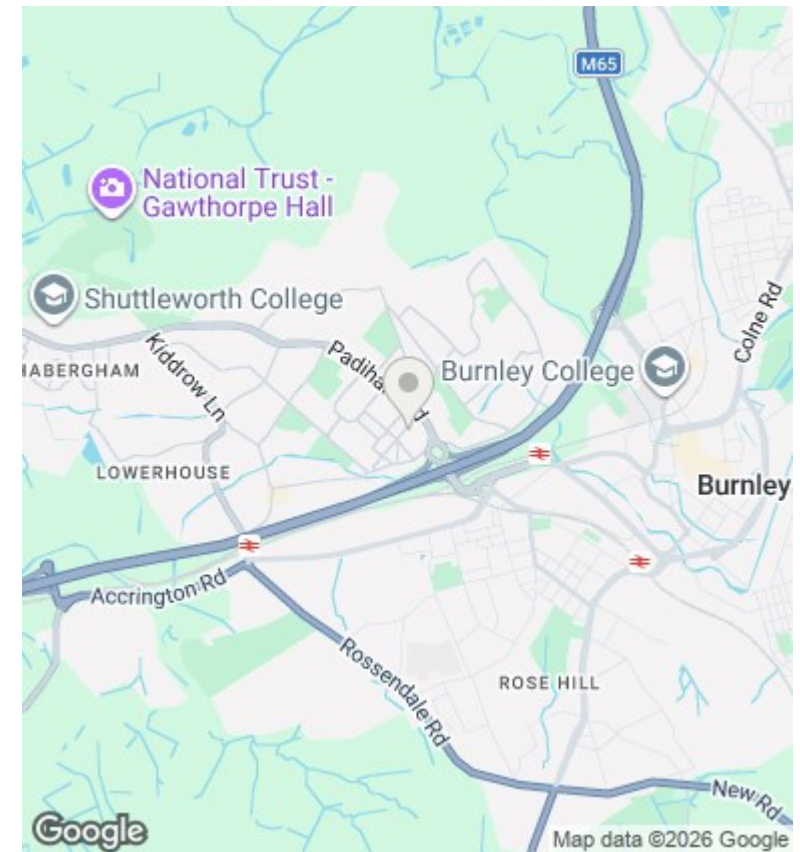

## Directions

## Viewings

Viewings by arrangement only. Call 0113 3224 345 to make an appointment.

## Council Tax Band

## EPC Rating:

Energy Efficiency Rating		
	Current	Potential
<i>Very energy efficient - lower running costs</i>		
(92 plus) <b>A</b>		
(81-91) <b>B</b>		
(69-80) <b>C</b>		
(55-68) <b>D</b>		
(39-54) <b>E</b>		
(21-38) <b>F</b>		
(1-20) <b>G</b>		
<i>Not energy efficient - higher running costs</i>		
<b>England &amp; Wales</b>	EU Directive 2002/91/EC	